

1 Coffrage

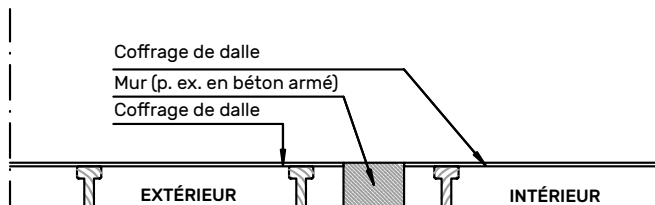

2 Pose des consoles isolantes FIRIKA®

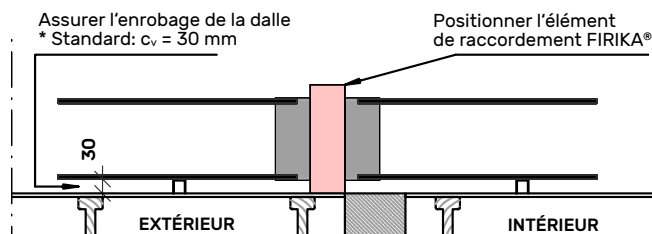

3 Armature inférieure et étriers

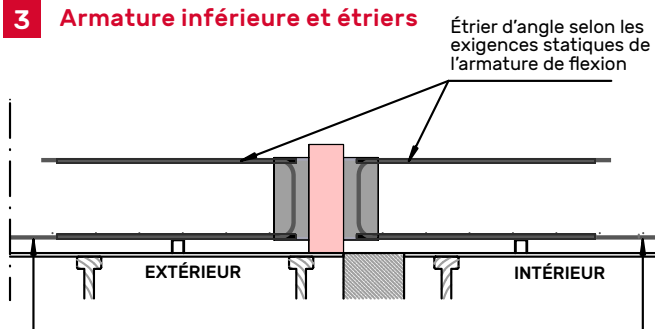

Insérer l'armature inférieure et fixer à l'aide d'un élément de raccordement FIRIKA®

4 Armature supérieure

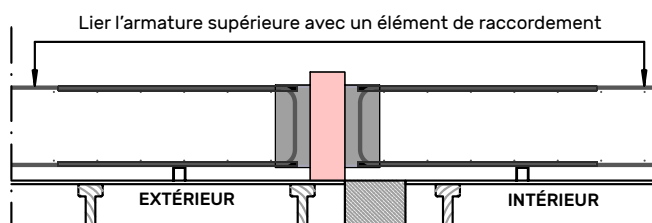

5 Bétonnage

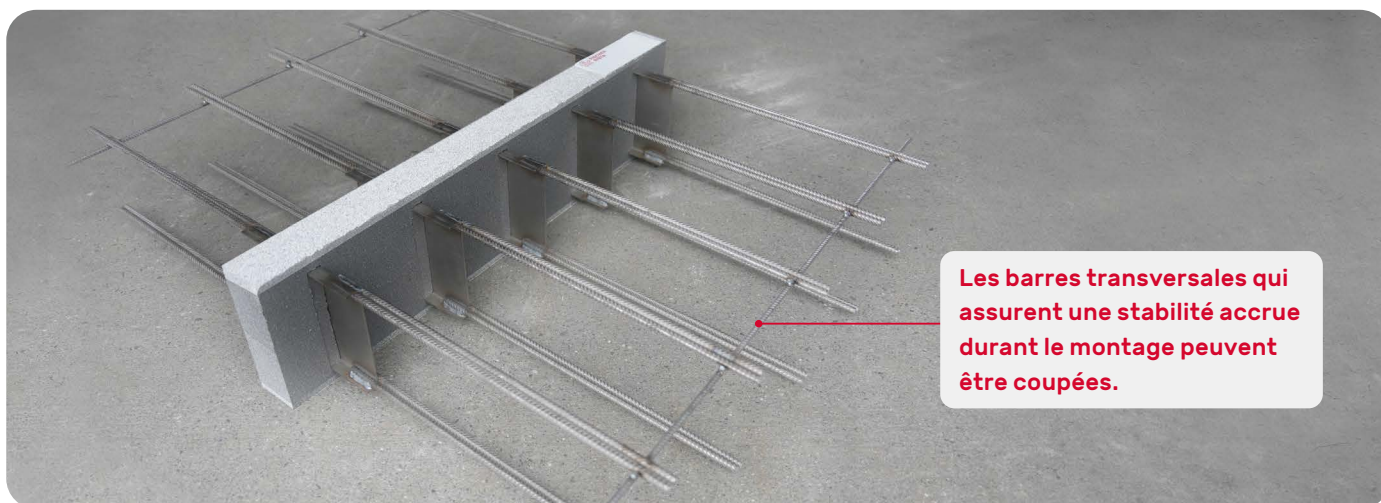
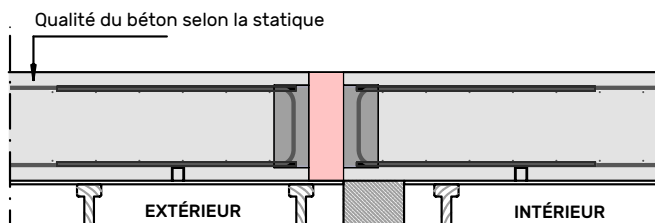

Les barres transversales qui assurent une stabilité accrue durant le montage peuvent être coupées.